

### ELEVATION

### SECTION B-B

|                   |                       |
|-------------------|-----------------------|
| Average U Value   | 1.3W/m <sup>2</sup> K |
| CEN standard      |                       |
| Glazing Thickness | 28mm                  |
| Testing           |                       |
| Security          | PAS24 & SBD           |
| BS6375 - 1        | ✓                     |
| BS6375 - 2        | ✓                     |
| BS6375 - 3        | ✓                     |

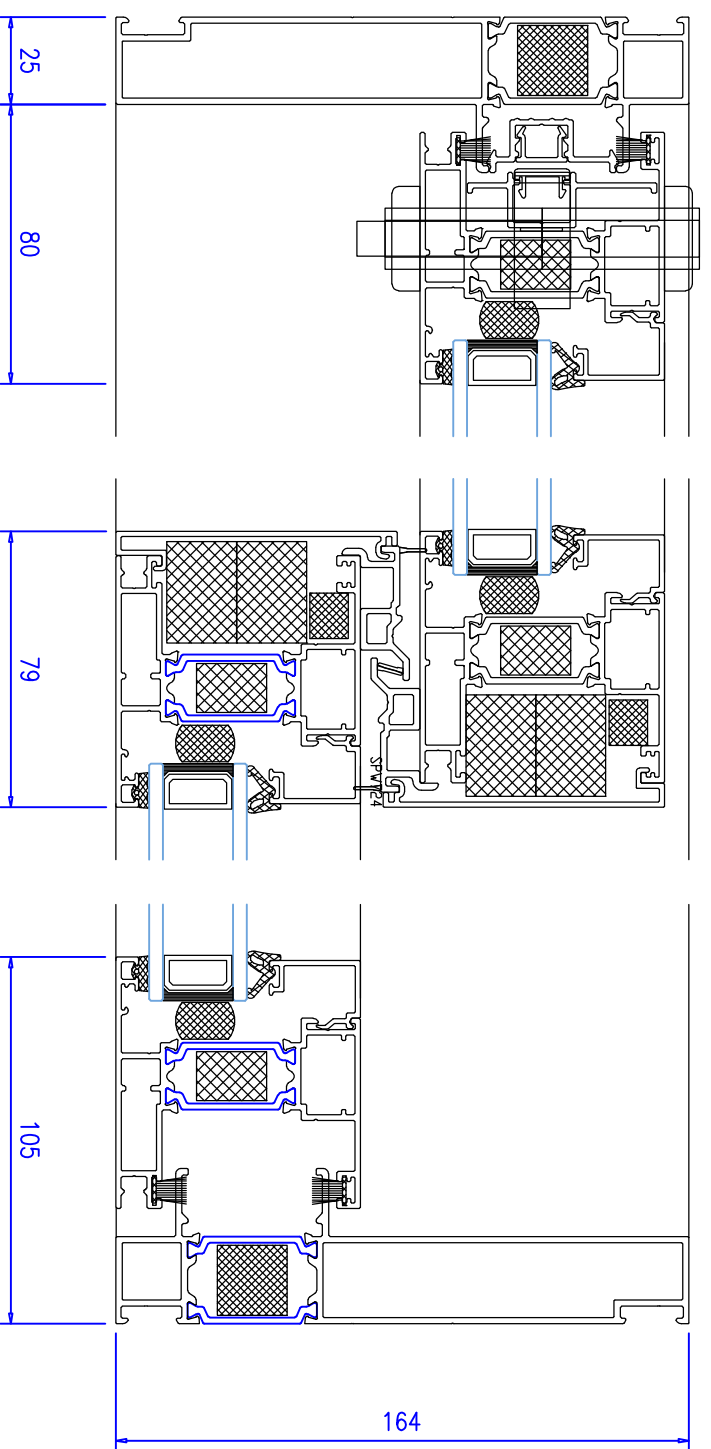

### SECTION A-A